



| Product name | Size* | Weight | Material | Item no. | Product picture |
|----------------|-----------------|------------|-----------------|----------|---|
| VET 1 | 115×65 cm (L×B) | ca. 1.200g | 98% PES / 2% PU | 2VT001 |  |
| VET 1.5 | 100×55 cm (L×B) | ca. 830g | 98% PES / 2% PU | 2VT015 |  |
| VET 2 | 55×65 cm (L×B) | ca. 450g | 98% PES / 2% PU | 2VT002 |  |

*The textile products shrink by 3–5% during the first reprocessing cycles. Furthermore, the dimensions are based on a tolerance value of ±2 cm.

PRODUCT DESCRIPTION

Reusable convective air warming mat for patient temperature control from below

APPLICATION

- ▶ Place the warming mat with the **white side** on the operating table – **fig. 1**
- ▶ Push the hose end of the air warming device into one of the connection openings of the warming mat 10 cm behind the Velcro fastener and fix the hose with the Velcro fastener; if using an air warming device with two hoses, both tubes are connected accordingly – **fig. 2**
- ▶ Switch on and operate the air warming device according to the operating instructions – **fig. 3**
- ▶ **NOTE:** Only use forced air warming devices that are approved for convective patient warming
- ▶ Position the patient on the **green side** (= patient side) of the warming mat – **fig. 4**
- ▶ **TIP:** Best results are achieved in combination with our warm air unit **TWINWARM BB**

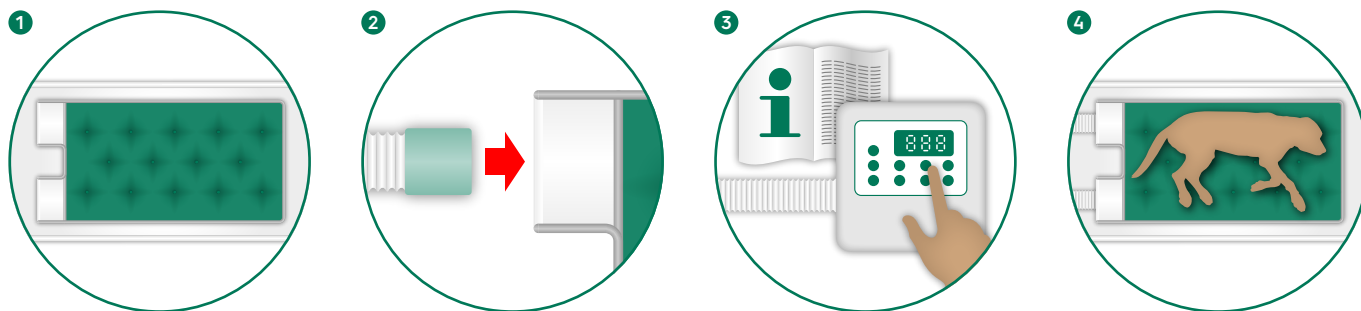

ATTENTION

To ensure an even flow of warm air and to avoid thermal damage, do not apply any foils or similar between the patient and the warming mat. The warming pad may only be used for veterinary patients.

TEXTILE CARE

- ▶ **WASHING:** When filling the washing machine, make sure that the warming mat is folded with the green side facing outwards
- ▶ Please only fill the drum of the washing machine up to half full
- ▶ The warming mat should only be washed using a gentle cycle at 60° – but not more than 70°
- ▶ Ensure a low spin speed of 600 to 800 rotations
- ▶ **DRYING:** The warming mat can be dried in the tumble dryer
- ▶ **HYGIENE:** Heavy-duty detergent with disinfectant content
- ▶ **TIP:** We recommend using a washing net



Max. 70°C mild wash



Normal drying process





Do not iron



Only oxygen bleach

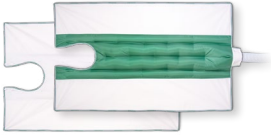

Professional dry-cleaning

| Product name | Size* | Weight | Material | Item no. | Product picture |
|--|-----------------|-----------|--|----------|---|
| WARMING BLANKET VET 1 / VET 1.5 | 150×95 cm (L×B) | ca. 370 g | 98% PES / 2% PU | 2VT010 |  |
| CONNECTING HOSE | 80×8 cm (L×B) | ca. 400 g | Silicone Efrosil 200/60 green / Special PVC / Cellular rubber | 2VT011 |  |

* The textile products shrink by 3–5% during the first reprocessing cycles. Furthermore, the dimensions are based on a tolerance value of ±2 cm.

**Connecting hose is only required if using a air warming device with only one hose

PRODUCT DESCRIPTION

Reusable convective warming blanket with variable head/neck cut-out for patient temperature control in veterinary medicine. Particularly suitable for dental procedures.

APPLICATION

- ▶ Prepare the warming mat according to the instruction manual and place the patient on it – **fig. 1**
- ▶ Place the warming blanket with the **green side** on the patient so that the patient is completely covered – **fig. 2**
- ▶ Push the ends of the connecting hose about 10 cm into the connection opening of the warming blanket such as the warming mat behind the Velcro fastener and fixate it with that – **fig. 3 + 4**

When using an air warming device with two hoses, both tubes are connected directly to the warming blanket

- ▶ Button up the variable round neckline according to the patient's head size
- ▶ Overlapping side parts are folded under the warming mat – **fig. 5**



ATTENTION

To ensure an even flow of warm air and to avoid thermal damage, do not apply any foils or similar between the patient and the warming mat. The warming pad may only be used for veterinary patients.

TEXTILE CARE

- ▶ **WASHING:** When filling the washing machine, make sure that the warming blanket is folded with the green side facing outwards
- ▶ Please only fill the drum of the washing machine up to half full
- ▶ The warming blanket should only be washed using a gentle cycle at 60° – but not more than 70°
- ▶ Ensure a low spin speed of 600 to 800 rotations
- ▶ **DRYING:** The warming blanket can be dried in the tumble dryer
- ▶ **HYGIENE:** Heavy-duty detergent with disinfectant content
- ▶ **TIP:** We recommend using a washing net



Max. 70°C mild wash



Normal drying process



Do not iron



Only oxygen bleach



Professional dry-cleaning